



Beam clamps type CCL

Beam clamps in galvanized steel

Brand

- SUFIX

Application

- They are used for the mounting of parts of airconditioning and ventilation systems on beams of max 19 mm thickness
- In combination with threaded rods

Models

- Available for threads of M6, M8 or M10

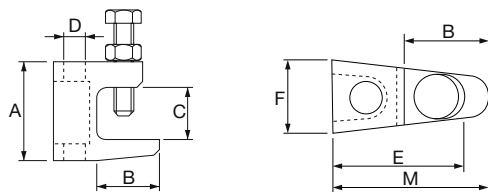

	Dimensions						
	A [mm]	B [mm]	C [mm]	D [mm]	E [mm]	F [mm]	M [mm]
CCL M6	36	21	18	M6	35	18	38
CCL M8	36	21	20	M8	35	18	38
CCL M10	42	23	20	M10	41	21	44