

- Air valves
- Steel
- White, RAL 9016
- Extraction



Steel exhaust valves type EVA (RAL9016)

Air extraction valves with adjustable core

Brand

- Cairox

Application

- For air extraction in ventilation systems
- Suitable for small spaces such as toilets, storage room, bathroom, etc.

Material

- Steel

Colour

- Standard colour white, RAL 9016

Composition

- Pressed steel body with adjustable core, supplied with galvanized steel mounting frame

Mounting

- Fixing by clips in the mounting frame
- Can also be used for direct mounting into round duct (with or without mountingframe)

Accessories

- Mounting ring **TR** for clamping the mounting frame on tile ceiling plates

Order example

- **EVA, 125**

Explanation

EVA = Type valve (incl. mountingframe)

125 = Connection diameter

Symbols and specifications

- Q = Air volume in m³/h
- Ps = Static pressure loss in Pa
- Lw(A) = Acoustic power in dB(A), based upon measured Lp acoustic pressures increased by 4 dB(A) room attenuation
- r = -20 mm, 0, +20 mm = Distance between the face of the central cone and the valve border

Selection Graph

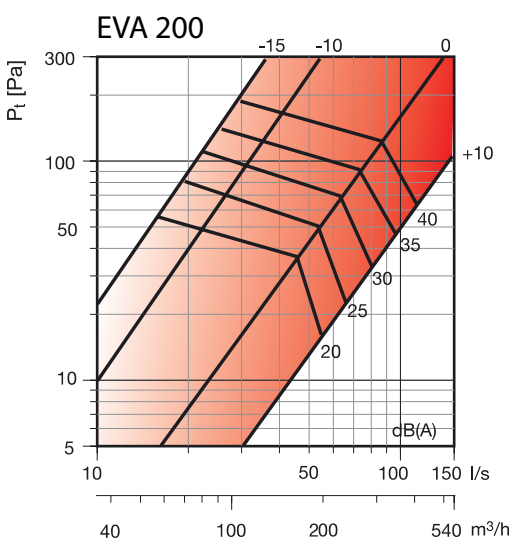
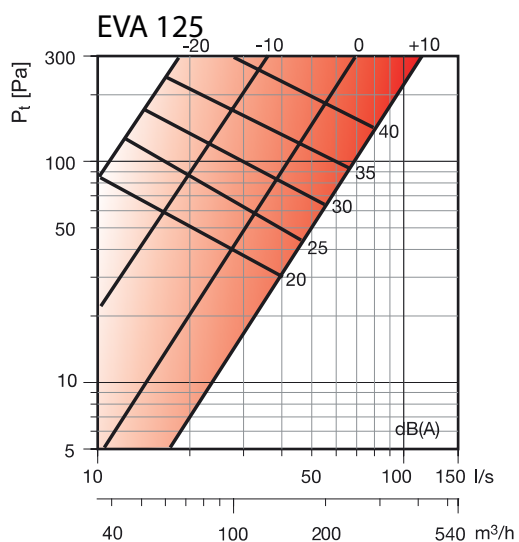
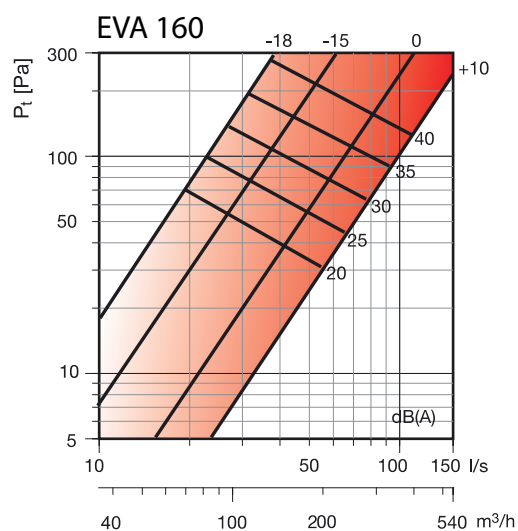
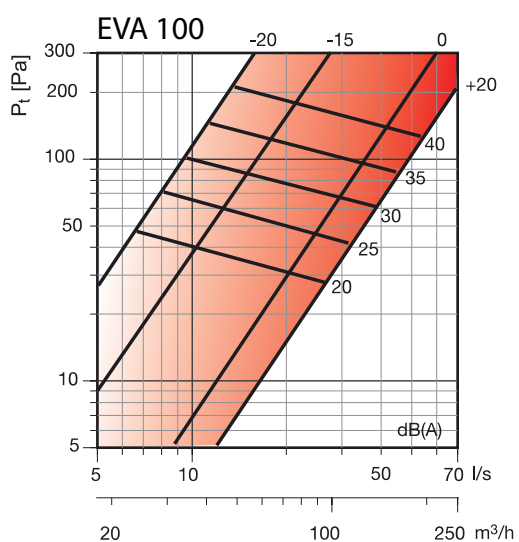
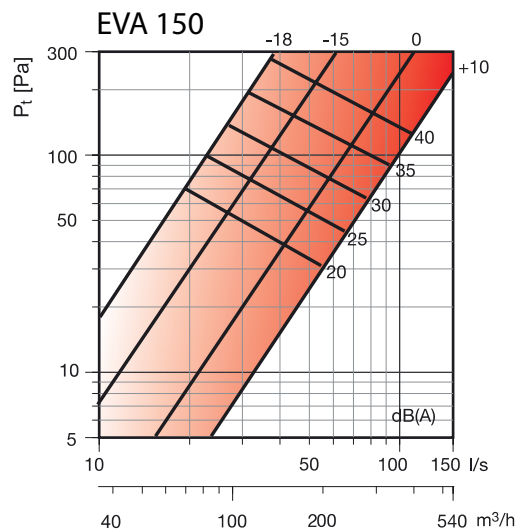
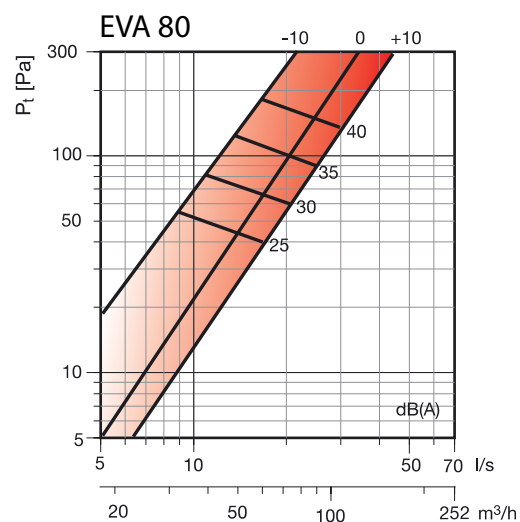

Air valves

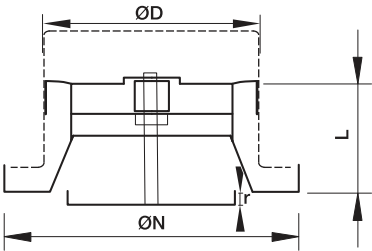

Dimensions			
	ØD [mm]	ØN [mm]	L [mm]
EVA 100	100	135	60
EVA 125	125	160	60
EVA 160	160	195	60
EVA 200	200	238	63