

Fire dampers Rf1 h, with valve type SC60+V

Type

Fire dampers SC60+V offer a solution for small diameters. Two half round blades are held together by a fusible link. When the temperature rises above 70°C the fusible link will break. Thereby the two half blades are released and the fire damper is shut, preventing smoke or flames from passing through. An exhaust valve in the same diameter is included.

Application

- Closing ventilation ducts in case of fire
- Fire resistant for 1 hour
- For air of +5°C up to +50°C with maximum RV 95% (NON-condensating!)
- To be mounted horizontally or vertically
- Only Size 100 and 125 to be used in Belgium, also available in size 160 and 200 for other counties upon request

Material

- Steel

Colour

- White

Composition

- Steel tunnel
- Fusible link 72°C
- 1. Steel tunnel
- 2. Two semi circular blades
- 3. Intumescent strip around the tunnel
- 4. Rubber sealing ring
- 5. Fusible link 72°C
- 6. Two blocking hooks
- 7. End of range switch (option)
- 8. Finishing ventilation valve
- 9. Product identification

Fire dampers

Mounting

- To be inserted in round ducts, passing fireproof walls or floors
- Valve easily fits onto the fire damper

Certification

- Approved according EN 1366-2
- Classification:
- EI 60 ($v_{e,h_0} o \leftarrow i$)S (300 Pa)

Accessories

- **FCU SC** end of range switch

Order example

- **SC60+V, 125**

Explanation

SC60+V = Round butterfly fire damper Rf 60 minutes, exhaust valve included

125 = duct diameter

		Quick selection			
	Qv	100*	125*	160*	200**
25	Ps	5			
	Lw	23			
50	Ps	36	25		
	Lw	33	27		
75	Ps		48	37	
	Lw		35	32	
100	Ps		88	62	28
	Lw		43	39	-
125	Ps				39
	Lw				26
150	Ps				50
	Lw				30
200	Ps				92
	Lw				39

Symbols and specifications

- Qv = Air volume in m³/h
- Ps = Static pressure in Pa
- Lw = Acoustic power in dB(A)
- * Data at opened valve, +10 turns opened
- ** Data at opened valve, +20 turns opened

product drawing

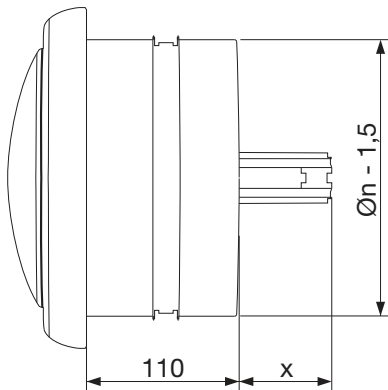

Type	Dimensions		
	Ød [mm]	Ød-1,5 [mm]	X [mm]
100	100	98.5	18
125	125	123.5	31
160	160	158.5	49
200	200	198.5	69